

150 REINFORCED CONCRETE PAVEMENT
 75 BASE COURSE MATERIAL
 375 CRUSHED SUB BASE MATERIAL
 (MAX. SIZE 50mm)
 GEOGRID
 SEPARATION GEOTEXTILE FABRIC
 PREPARED SUBGRADE

TYPICAL CROSS SECTION
 N.T.S.

- REFERENCE NOTES**
- PAVEMENT DIMENSIONS ARE TO BACK OF CURB
 - BASELINE IS CENTRE LINE RIGHT-OF-WAY
 - PROPERTY LINES OBTAINED FROM CITY OF WINNIPEG L.B.I.S., AND NO SCALE FACTOR WAS APPLIED
 - REFER TO AECOM FIELD BOOK NO. 5035

- CONSTRUCTION NOTES**
- REMOVE EXISTING PAVEMENT AND CONSTRUCT NEW 150mm REINFORCED CONCRETE PAVEMENT
 - CONSTRUCT NEW BARRIER CURB (180mm HT. INTEGRAL)
 - CONSTRUCT NEW MODIFIED BARRIER CURB (180mm HT. INTEGRAL)
 - CONSTRUCT NEW CURB RAMP (8-12mm HT. INTEGRAL)
 - RENEW EXISTING 100mm CONCRETE SIDEWALK
 - REMOVE EXISTING CATCHBASIN / CATCHPIT AND ABANDON LEAD
 - INSTALL NEW CURB AND GUTTER INLET c/w CATCHBASIN 1800mm (SD-024) AND CONNECT TO EXISTING 600mm CLAY COMBINED SEWER
 - INSTALL 150mm SUBDRAIN
 - REMOVE EXISTING FRAME AND COVER AND PLACE NEW FRAME AND COVER (AP-006/AP-007)
 - ADJUST EXISTING MANHOLE / CATCHBASIN FRAME TO GRADE
 - INSTALL NEW CAST IRON RISER RING
 - ADJUST EXISTING WATER VALVE TO GRADE
 - REGRADE EXISTING PAVING STONES
 - REMOVE EXISTING PAVEMENT AND CONSTRUCT NEW ASPHALTIC PAVEMENT TYPE 1A (75mm)
 - INSTALL NEW DETECTABLE WARNING SURFACE TILE
 - ADJUST EXISTING CURB STOP
 - REGRADE EXISTING RIVER ROCK

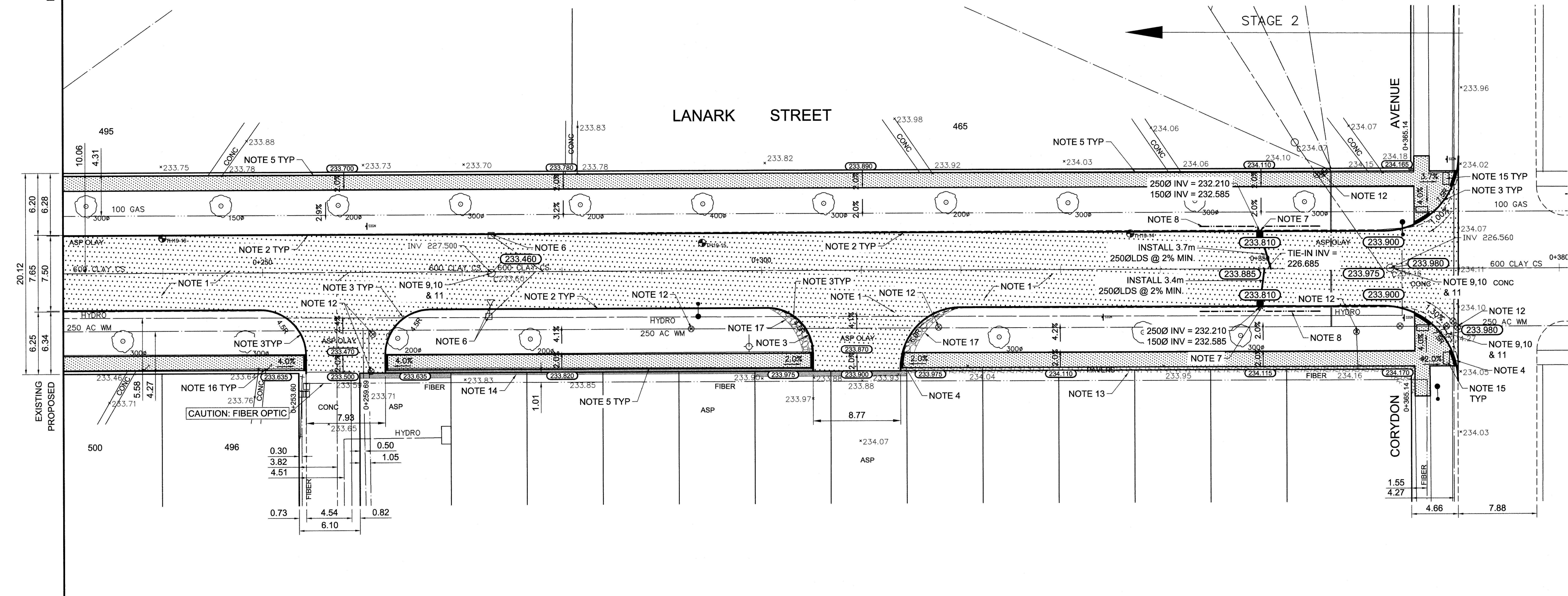

AECOM
 Certificate of Authorization
 AECOM Canada Ltd.
 No. 4671 Date: Dec 6/19

METRIC
 WHOLE NUMBERS INDICATE MILLIMETRES
 DECIMALIZED NUMBERS INDICATE METRES

EXISTING	LEGEND - PLAN	PROPOSED	EXISTING	LEGEND - PLAN	PROPOSED	EXISTING	LEGEND - PROFILE	PROPOSED
150mm W.M.	WATERMAIN	150mm W.M.	---	HYDRO	---	---	Q PROFILE	---
Hydrant	HYDRANT	Hydrant	---	M.T.S.	---	---	WEST GUTTER	---
Valve	VALVE	Valve	---	CONCRETE	---	---	EAST GUTTER	---
300mm L.D.S.	LAND DRAINAGE SEWER	300mm L.D.S.	---	ASPHALT	---	---	N/W PROPERTY LINE	---
250mm W.W.S.	WASTEWATER SEWER	250mm W.W.S.	---	PROPERTY LINE	---	---	S/E PROPERTY LINE	---
Manhole	MANHOLE	Manhole	---	SURVEY BAR	---	---		
Catch Basin	CATCH BASIN	Catch Basin	---	ELEVATION	(235.750)	---		
Catch Pit	CATCH PIT	Catch Pit	---	TREE	---	---		
Junctions	JUNCTIONS	Junctions	---	SIDEWALK RAMP	---	---		
Culvert	CULVERT	Culvert	---	CONCRETE SIDEWALK	---	---		
Gas	GAS	Gas	---	FENCE	---	---		

LOCATION APPROVED UNDERGROUND STRUCTURES

SUPV. / U/G STRUCTURES COMMITTEE DATE

NOTE:
 LOCATION OF UNDERGROUND STRUCTURES AS SHOWN ARE BASED ON THE BEST INFORMATION AVAILABLE. BUT NO GUARANTEE IS GIVEN THAT ALL EXISTING UTILITIES ARE SHOWN OR THAT THE GIVEN LOCATIONS ARE EXACT. CONFIRMATION OF EXISTENCE AND EXACT LOCATION OF ALL SERVICES MUST BE OBTAINED FROM THE INDIVIDUAL UTILITIES BEFORE PROCEEDING WITH CONSTRUCTION.

B.M. 51-024	909539 - 0 W. Cor. John Brebuef Pl. & Central St. Brass plug in 4.6 m Conc. pile, 2.7 m N. of S.L. John Brebuef Pl. & 0.6 m W. of W.L. Central St.		
ELEV. 233.661			
0	ISSUED FOR TENDER	12/06/2019	BC
A	ISSUED FOR REVIEW	04/04/2019	BC
NO.	REVISIONS	DATE	BY

AECOM

DESIGNED BY: JC CHECKED BY: BC

DRAWN BY: JT/JC APPROVED BY:

HOR. SCALE: 1:250 RELEASED FOR CONSTRUCTION BY:

VERTICAL: 1:10

DATE: Dec 5/19

ENGINEER'S SEAL

PROVINCE OF MANITOBA

K.W. RAE

REGISTERED PROFESSIONAL ENGINEER

CONSULTANT DRAWING NO. CT-03

THE CITY OF WINNIPEG
 PUBLIC WORKS DEPARTMENT
 ENGINEERING DIVISION

2019 RESIDENTIAL STREET RENEWAL PROGRAM

LANARK STREET - JOHN BREBUEF PLACE - CORYDON AVENUE

PAVEMENT RECONSTRUCTION
 STATION 0+230 TO CORYDON AVENUE

CITY DRAWING NUMBER SHEET 03 OF 10